

SOUTH MELBOURNE 151 Napier Street

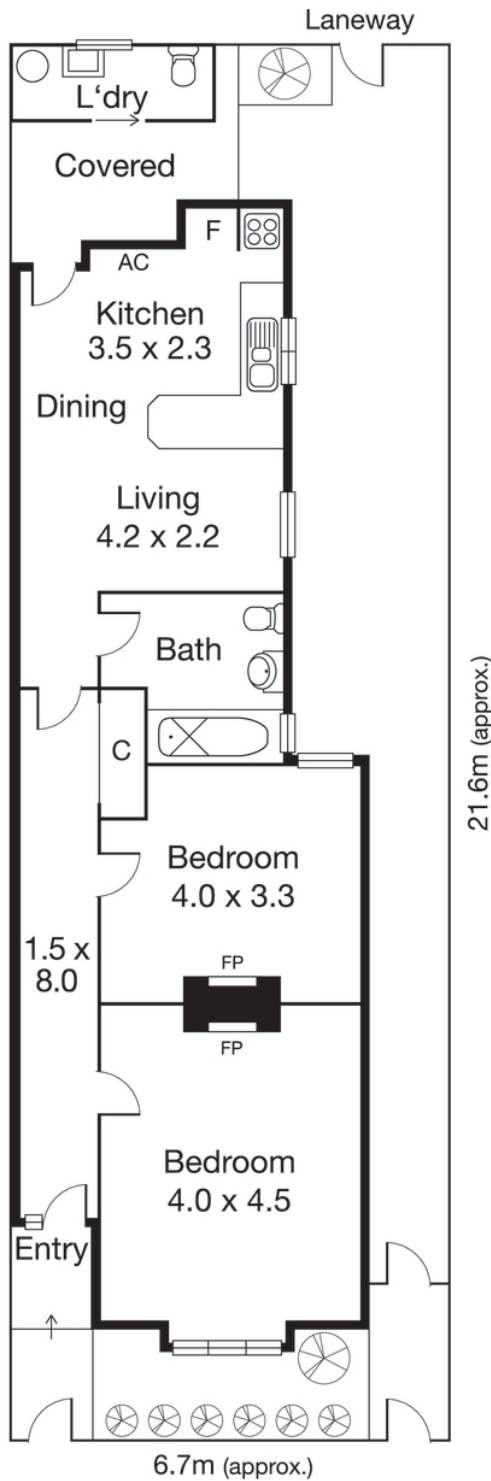

CAYZER

SOUTH MELBOURNE 151 Napier Street



EXCEPTIONAL OPPORTUNITY IN PRIZED LOCALE

- Stained leadlight windows, Baltic timber floors and open fire places throughout
- Comfortable living now yet offers outstanding renovation potential (STCA)
- Short stroll to Clarendon Street, Albert Park Lake & MSAC and South Melbourne Market

Rich in period character throughout this extra wide (6.7m frontage approx.) semi - detached Edwardian is positioned in one of South Melbourne's most coveted locations. Comprising: Wide hallway entrance, two enormous bedrooms (front with bay window), fully tiled central bathroom, functional kitchen adjacent living / meals which leads to outside laundry / storage plus paved courtyard with rear laneway and side access.

🏠 2 🛏 1

AUCTION Saturday 13 November at 11am

Inspection As advertised or by appointment

Contact Simon Carruthers 0438 811 601
Charlotte Broussard 0403 451 899
Geoff Cayzer 03 9690 9782

Mel Ref 57 H2

CAYZER

Albert Park 330 Montague Street 03 9699 5999
Port Melbourne 370 Bay Street 03 9646 0812

cayzer.com.au